

CP152

CLAMPING MODULES (Single)

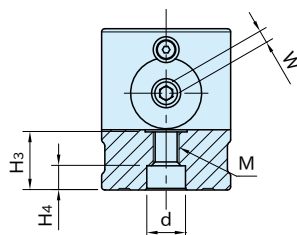

CP152 -06032

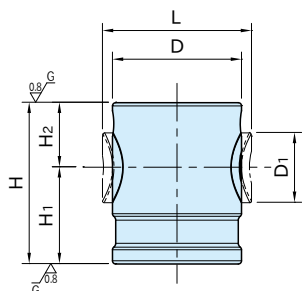
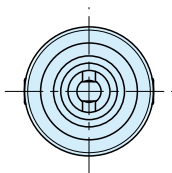

CP152 -08050, 12080, 16100

Body	Clamping Nut	Locking Screw
SCM440 steel Induction hardened Black oxide finished Precision ground	SCM440 steel Quenched and tempered Black oxide finished	SCM435 steel Quenched and tempered Black oxide finished

Part Number	D	H (±0.01)	D ₁	L	H ₁	H ₂	H ₃	d (H7)	H ₄	M	W
CP152-06032	30	32	15	34.5	19.5	12.5	11.5	8	5	M 6×1	3
CP152-08050	40	50	22	46	30	20	18	12	7.5	M 8×1.25	4
CP152-12080	60	80	32	69	50	30	25	18	10.5	M12×1.75	6
CP152-16100	80	100	44	91	60	40	31	22	12.5	M16×2	8

Part Number	Clamping Force (kN)	Allowable Screw Torque (N·m)	Weight (kg)
CP152-06032	5	4	0.2
CP152-08050	8	8	0.5
CP152-12080	15	22	1.6
CP152-16100	25	50	3.8

Related Product

- **CP150** Clamping Modules (Flanged)
- **CP151** Clamping Modules (Double)
- **CP155-L** Tapered Clamping Screws
- **CP155-D** Tapered Clamping Screws
- **CP156** Clamping Screws
- **CP159** Locating Bushings

Technical Information

Allowable Cutting Force & Workpiece Weight of
CLAMPING MODULES

How To Use

- Use **CP159** Locating Bushing for precise locating.
- Use only hex. socket-head cap screw just for fixing.

Mounting-Hole Dimension

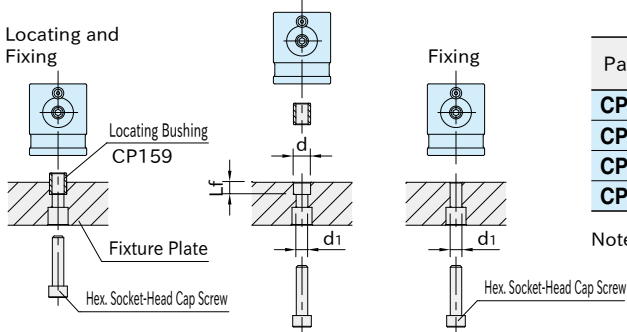

Part Number	d (H7)	Lf	d1 ($+0.2$ 0)
CP152-06032	8	6.5	6
CP152-08050	12	8.5	8
CP152-12080	18	12.5	12
CP152-16100	22	16.5	16

Note: Only c'bored hole is required just for fixing.

Spacing Tolerance

Spacing tolerance for CP159 Locating Bushings should be ± 0.02 .

*) Spacing tolerance for hex. socket-head cap screw should be ± 0.1 .

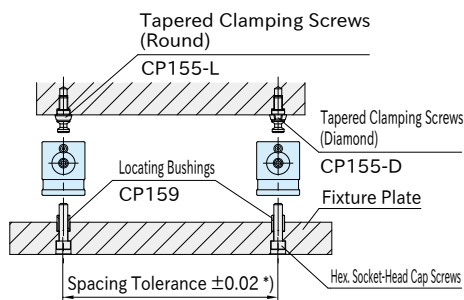

Coupling with Other Clamping Modules

Can be coupled with each Clamping Module.
<Locating Repeatability is $5 \mu\text{m}$ >

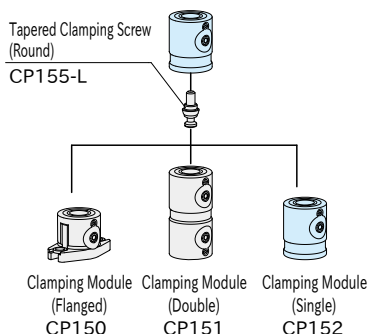

Tightening Order

Tighten the locking screws in order of 1(Round Tapered Clamping Screw)→2(Diamond Tapered Clamping Screw)→3(Clamping Screw)→4(Clamping Screw).

Note: For **CP152**-06032, use 2 pieces of Round Tapered Clamping Screw.

Tighten these 2 screws in the same order to maintain the locating repeatability.

