

Rubber Tip Spindles
RT with 2 Nuts and 2 Washers

Model No.	A	B	C	D	Weight Kgs	Stainless Steel Model No.
RT-420-2N2W	9	24	19	M4	0.004	RT-420-2N2W-SS
RT-529-2N2W	11	29	24	M5	0.009	RT-529-2N2W-SS
RT-533-2N2W	12	33	24	M5	0.009	RT-533-2N2W-SS
RT-539-2N2W	12	39	30	M5	0.010	RT-539-2N2W-SS
RT-645-2N2W	15	46	33	M6	0.020	RT-645-2N2W-SS
RT-655-2N2W	15	55	42	M6	0.020	RT-655-2N2W-SS
RT-865-2N2W	18	66	50	M8	0.040	RT-865-2N2W-SS
RT-1085-2N2W	23	86	66	M10	0.080	RT-1085-2N2W-SS
RT-12115-2N2W	23	116	97	M12	0.130	-
RT-12155-2N2W	23	163	144	M12	0.160	-
RT-16170-2N2W	32	173	147	M16	0.310	-

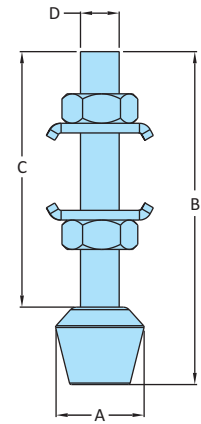

Nylon Tip Spindles-NT
NT with 2 Nuts and 2 Washers

Model No.	A	B	C	D	Weight Kgs
NT-645-2N2W	15	48	35	M6	0.020
NT-865-2N2W	18	72	55	M8	0.040
NT-1085-2N2W	24	90	70	M10	0.080
NT-12115-2N2W	24	120	102	M12	0.130
NT-12155-2N2W	24	160	142	M12	0.130
NT-16170-2N2W	32	173	147	M16	0.320

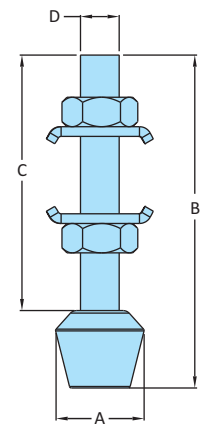

Swivel Foot Spindles
SW with 2 Nuts

Model No.	A	B	C	D	Weight Kgs
SW-645-2N	12.5	60	36	M6	0.030
SW-865-2N	16	85	63	M8	0.060
SW-1085-2N	19	102	75	M10	0.110
SW-12115-2N	19	133	105	M12	0.170
SW-12155-2N	19	173	144	M12	0.190
SW-16170-2N	50	190	155	M16	0.600

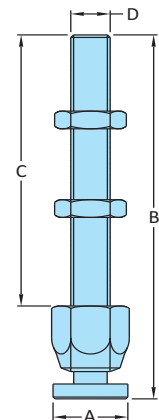

Large Diameter Swivel Foot Spindles
LDSW with 2 Nuts

Model No.	A	B	C	D	Weight Kgs
LDSW-645-2N	25	60	36	M6	0.060
LDSW-865-2N	32	85	63	M8	0.120
LDSW-1085-2N	38	102	75	M10	0.230
LDSW-12115-2N	38	133	105	M12	0.340
LDSW-12155-2N	38	173	144	M12	0.390
LDSW-16170-2N	100	190	155	M16	1.200

